

(DAWNN1.DAWNN) 20086  
DAWNN ONE DEPARTURE

AL-6452 (FAA)

INDIANAPOLIS RGNL (MQJ)  
INDIANAPOLIS, INDIANA

TOP ALTITUDE:  
ASSIGNED BY ATC

AWOS-3  
124.175  
CLNC DEL  
119.25  
INDIANAPOLIS DEP CON  
127.15 317.8

BRICKYARD  
116.3 VHP  
Chan 110

R-098  
TERRE HAUTE  
115.3 TTH  
Chan 100

R-113  
HOOSIER  
110.2 OOM  
Chan 39

FOYTT RADAR  
N39°02.50'  
W86°16.85'

SNEVA  
RADAR  
N39°21.43'  
W86°18.96'

DAWNN  
N38°34.10'  
W86°13.72'  
10000  
(For LOUISVILLE Transition)

MYSTIC  
108.2 MYS  
N37°53.64'-W86°14.67'  
L-16, H-5-10

LOUISVILLE  
114.8 IU  
Chan 95  
N38°06.21'-W85°34.65'  
L-26-27, H-5-10

TAKEOFF MINIMUMS:  
Rwys 7, 16, 25: Standard.  
Rwy 34: 300-1 or standard with minimum climb  
of 347' per NM to 1100.

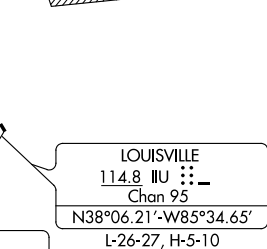
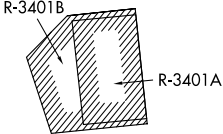
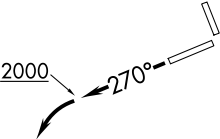

- NOTE: RADAR required.  
NOTE: Select appropriate localizer/DME frequency/channel prior to departure.  
NOTE: Turbojets accelerate to 250K until reaching 10000, if unable advise ATC.  
NOTE: Assigned to aircraft with a requested altitude of 11000 or above.

(NARRATIVE ON FOLLOWING PAGE)

NOTE: Chart not to scale.

DAWNN ONE DEPARTURE  
(DAWNN1.DAWNN) 07DEC17

INDIANAPOLIS, INDIANA  
INDIANAPOLIS RGNL (MQJ)

EC-2, 03 DEC 2020 to 31 DEC 2020

EC-2, 03 DEC 2020 to 31 DEC 2020